



Service poles
U24X · Colour aluminium

50

Selecting a service pole

Selecting a service pole in 4 steps:

Simple process in selecting a service pole.

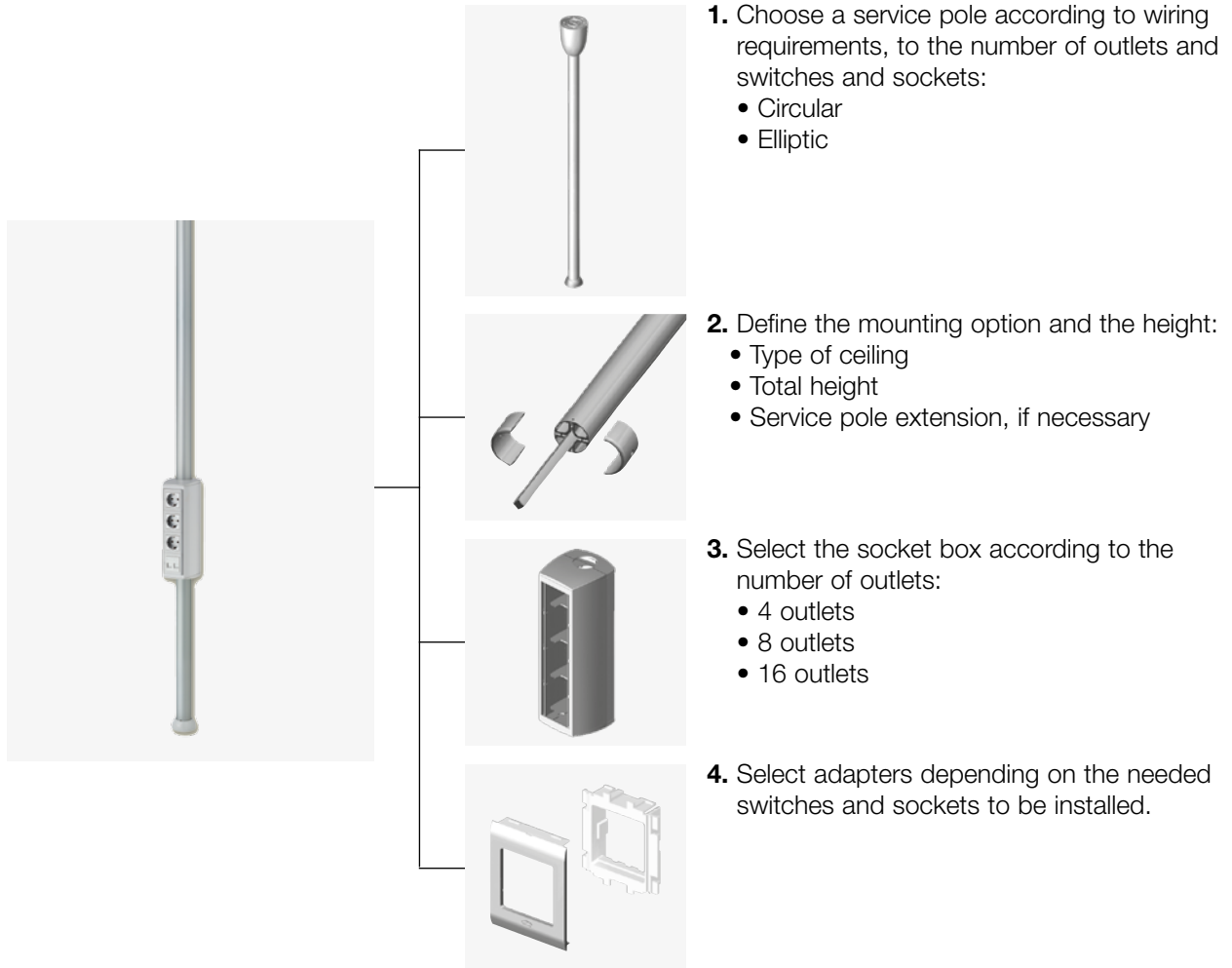



1. Choose a service pole according to wiring requirements: different cross-sections

Service pole cross-section
(4 compartments
each pole)

Data cables
(capacity in each compartment)

Power cables
(capacity in each compartment)

<p>Service pole 50 mm.</p> 	<p>○ 4 cables UTP 4 pairs. Maximum Ø5.1 mm.</p>	<p>⊗ 1 cable U1000 R2V 3x2.5 mm². Maximum Ø13 mm.</p>
<p>Service pole 50x88 mm.</p> 	<p>○ 8 cables STP 4 pairs. Maximum Ø7.4 mm. or ○ 14 cables UTP 4 pairs. Maximum Ø5.1 mm.</p>	<p>⊗ 4 cables U1000 R2V 3x2.5 mm². Maximum Ø10 mm. or ⊗ 2 cables U1000 R2V 3x2.5 mm². Maximum Ø13 mm.</p>

2. Define the mounting option and the height

Determine whether the mounting is from ceiling or suspended ceiling, and measure the total height in order to add, if necessary, a service pole extension.

Service pole 50 mm.
for suspended ceiling

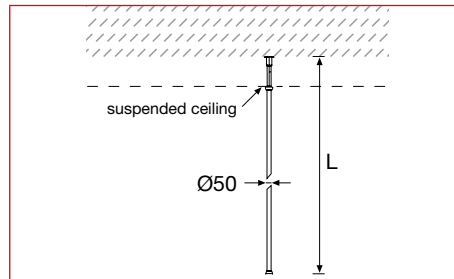

Service pole 50x88 mm.
for suspended ceiling

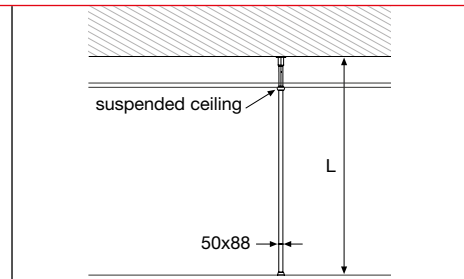

Service pole part no.	50003	50043
Max. Length (L)	3.10 m	3.14 m
Extension part no.	50094	50097
Max. Length (L) service pole + extension	4.10 m	4.14 m

3. Select the socket box according to the number of outlets

Socket box 4
outlets

Socket box 4+4
outlets

Socket box 8
outlets

Socket box 8+8
outlets

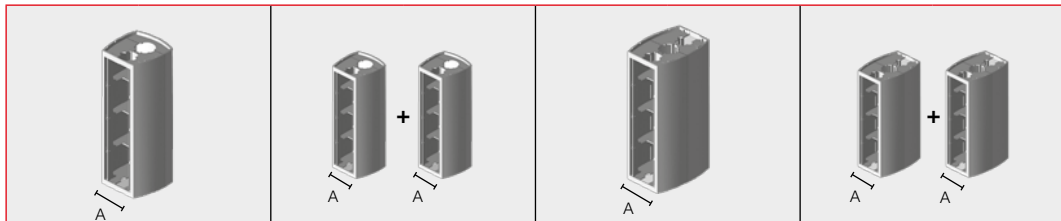

Outlets width (mm)	A	Socket box 4 outlets		Socket box 4+4 outlets		Socket box 8 outlets		Socket box 8+8 outlets	
		65	80	65	80	65	80	65	80
		50123	50124	50123 +	50124 +	50223	50224	50223 +	50224 +
			50144		50144 +		50244		50244 +

4. Select adapters according to switches and sockets (see pages 188-189)

